

V1 | August 2018

ULTRASKY FLAT SKYLIGHT INSTALLATION GUIDE

Dear Customer,

Thank you for choosing the Ultrasky Flat Skylight product. This guide is designed to make fitting as straightforward as possible.

Before you commence installation of the skylight, please take a moment to read this guide.

This guide is written on the basis that a qualified surveyor has undertaken correct checks for the capability / structural performance of any existing framework / walls / foundations to verify they are fit for purpose.

Please contact the Tech Support Team on **01200 452 918** or email **techsupport@ultraframe.co.uk**

IMPORTANT NOTES

- Take care when opening package
- Always wear appropriate PPE when handling glass; Cut level 5 gloves, cut resistant sleeves, eye protection.
- Ensure the skylight is fitted in the correct sequence and orientation.
- Check that the up stand is square by measuring diagonals

ASSEMBLIES & PARTS INCLUDED



Clip (FRICA001M)



Plasterboard trim (LVCT)



Self drilling screw (FRFC008-60)



Top assembly

PVCu welded base assembly

OPTIONAL
Ultraframe
bespoke kerb



90° Angle bracket (FRKBA001)



Tilt Fillet (NRPA/7)

NOT INCLUDED



50mm timber deck screws (suggested)

Screws supplied as required



100mm (FRFC008-100)



150mm (FRFC008-150)



200mm (FRFC008-200)



250mm (FRFC008-250)

Surplus fasteners may be supplied in some instances but do not require fitting.

TOOLS REQUIRED



Drill/ Screwdriver



Tape Measure



Spirit Level



Stanley Knife



Sealant Gun



5mm Drill Bit

KERB INSTALLATION

ULTRAFRAME KERB

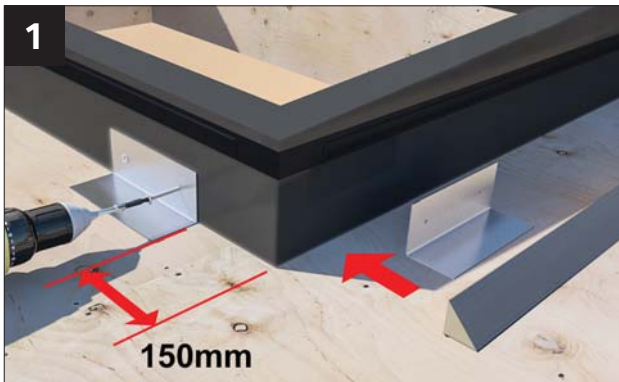

Align Ultraframe Kerb assembly with the aperture. Fix 90° angle bracket (FRKBA001) 150mm from end face using 2x self drilling screw (FRFC008-60) through pre drilled holes. Fix appropriately to existing roof using suitable screws (not supplied). Position 4x timber tilt fillets (NRPA/7) along the edge of the kerb to all sides.

FIT MEMBRANE PRE SKYLIGHT INSTALLATION

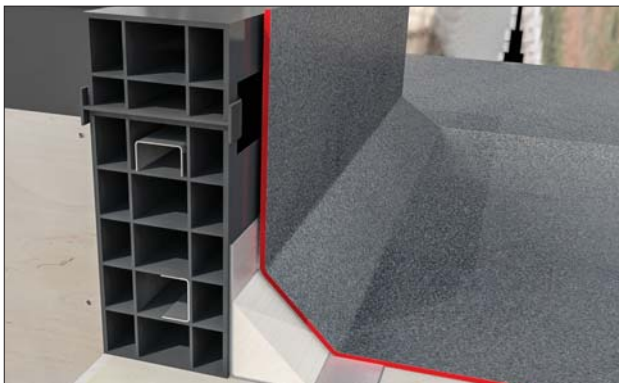

OPTION 1 - Wrap the membrane up to the top face of the kerb, knife flush and fix using sealant - ensuring that a watertight finish is achieved.

OPTION 2 - Lap the membrane over the top of the kerb ensuring that a watertight finish is achieved (this is the same as timber kerb process).

FIT MEMBRANE POST SKYLIGHT INSTALLATION

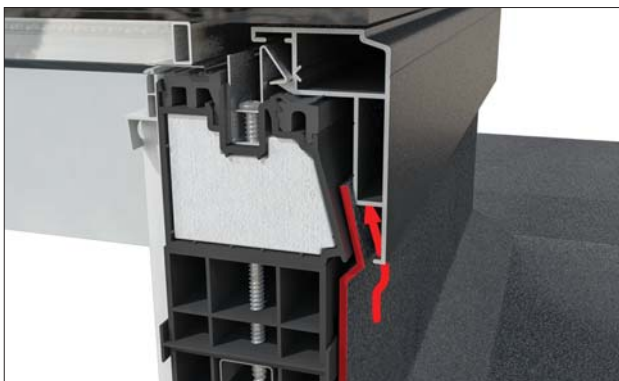

OPTION 3 - Wedge the membrane up behind the top assembly frame. Using an appropriate tool e.g. de-glazing tool.

CUSTOMER SUPPLIED KERB



Construct timber kerb. The kerb must be a minimum height of 150mm and rising at 4° (degrees) pitch x 70mm wide. Measure across diagonals to check squareness.

FIT MEMBRANE PRE SKYLIGHT INSTALLATION

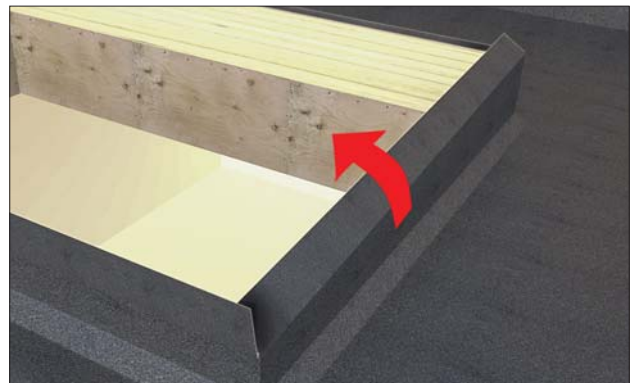

Lap the membrane over the top of the kerb ensuring that a watertight finish is achieved.

SCREW LENGTH SUPPLIED FOR KERB

Screw length supplied:

- 100mm (FRFC008-100)** - If customers supply their own kerb.
- 150mm (FRFC008-150)** - Always required with Ultraframe kerb.
- 200mm (FRFC008-200) or 250mm (FRFC008-250)** (supplied dependant on size).

NOTE: Longest screws supplied always used in top slope corners - 4 x corner clips.

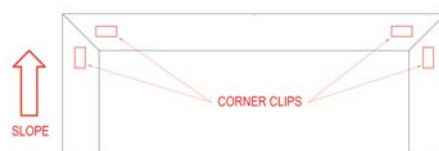

FLAT SKYLIGHT INSTALLATION

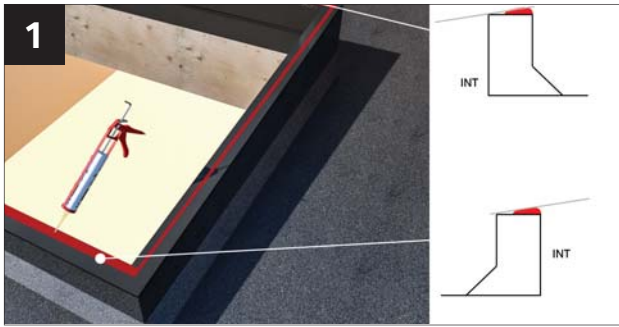

Apply a generous, continuous bead of silicone to the top surface of the kerb. **NOTE: If using an Ultraframe kerb, extra silicone is to be applied along the horizontals where the step is – See detail above.**



Position PVCu welded base assembly and align with internal kerb face.



Ensure you use all the clips provided. Position clips (FRICA001M) into pre drilled location holes and fix using screws (FRFC008) accordingly into kerb. **NOTE: Longest screws supplied always used in top slope corners - 4 x corner clips. (Refer to p3 for screw sizes).**



Fit the top glass assembly onto the PVCu frame. Carefully lower into position and then apply downwards pressure to opposite sides to activate clips locking feature. (You will hear a click). **NOTE: Larger units will require multiple persons to lift.**

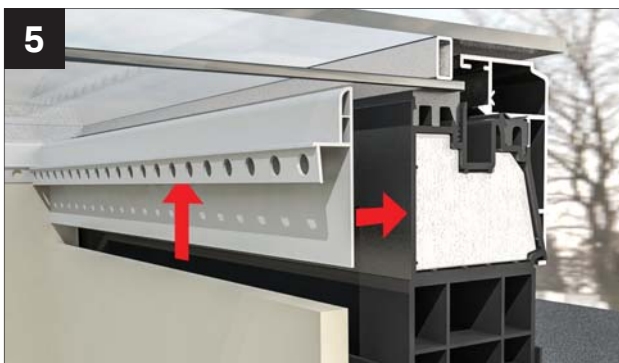

Plasterboard trim fitting -
OPTION ONE - Fit to edge of plasterboard and then fix plasterboard appropriately
OPTION TWO - Position as shown and then fix; using a countersunk screw and adhesive (not supplied) and then fit plasterboard.
NOTE: Top edge to be flush with internal glass.



INSTALLATION IS COMPLETE

www.ultraframetrade.co.uk

Ultraframe®
 Transforming light and space

Job No.: 3902 8/18 V1 FRIG001
 It is Ultraframe's policy to continually seek to improve its products, processes and services, and we reserve the right to change specifications without prior notice. Ultraframe is a trading name of Ultraframe (UK) Limited.